

Dear Customer,

This Quick Start Guide is enclosed with detailed washing machine operating instructions. Before using the appliance carefully read the Operating Instructions, especially guidelines for safe use.

Before plugging your appliance into the mains power, remove the transport bolts and level the appliance. Do not start the washing machine before it is properly set up.

Only wash delicate fabrics, synthetics, wool using designated programs. Only load such fabrics according a table of the maximum load sizes (see page 2).

The correct appliance operation extends its lifetime so make sure the drum seal is dry (leave the door ajar after washing). Clean the appliance with mild cleaning agents, do NOT scrub with abrasive agents.

1 Before you start washing



- Empty pockets
- Close all zips and button up duvet covers.
- Wash delicate and small items in a protective mesh laundry bag.
- Open the appliance door by pressing the handle on the inside.
- Insert the sorted clothes into the washing machine:
 - Cotton — max full drum.
 - Synthetics — max ½ of the drum.
 - Silk, wool — max ¼ of the drum.
- Close the door, press firmly against the seal.

2 Add detergent

- Open the detergent drawer by pulling the handle.
- Pour the recommended dose of washing detergent into the appropriate compartment of the detergent drawer.
- Add fabric conditioner to the appropriate compartment if required.
 - II MAIN WASH detergent.
 - III Fabric softener or other special care liquids
 - I PREWASH detergent.

3 Select a washing programme

- Set the programme selector knob to the desired programme.
- Customize the programme to your needs — you can change the temperature, spin speed, or enable additional features.
- Select additional functions - described in the "Table of programmes" (see page 2.).

4 Select START

- Close the appliance door.
- Turn the programme selector to the selected programme (see page 2.).
- Select additional functions or wash cycle parameters as required — according to your needs.
- Select Delay End ranging from 0 to 24 hours.
- Then press the START/ PAUSE button



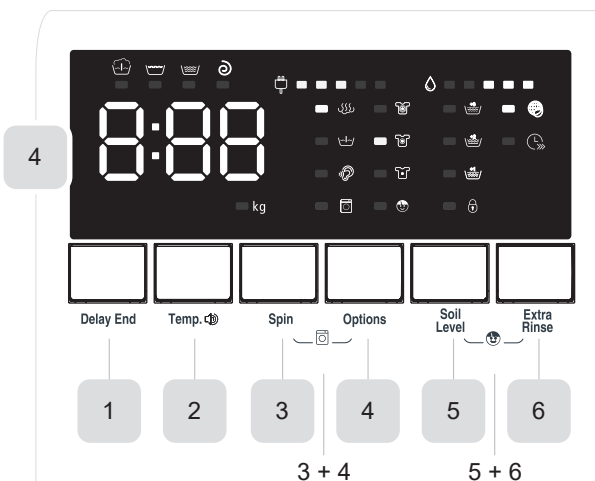
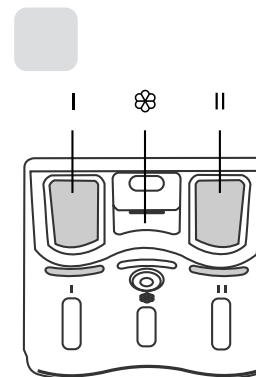
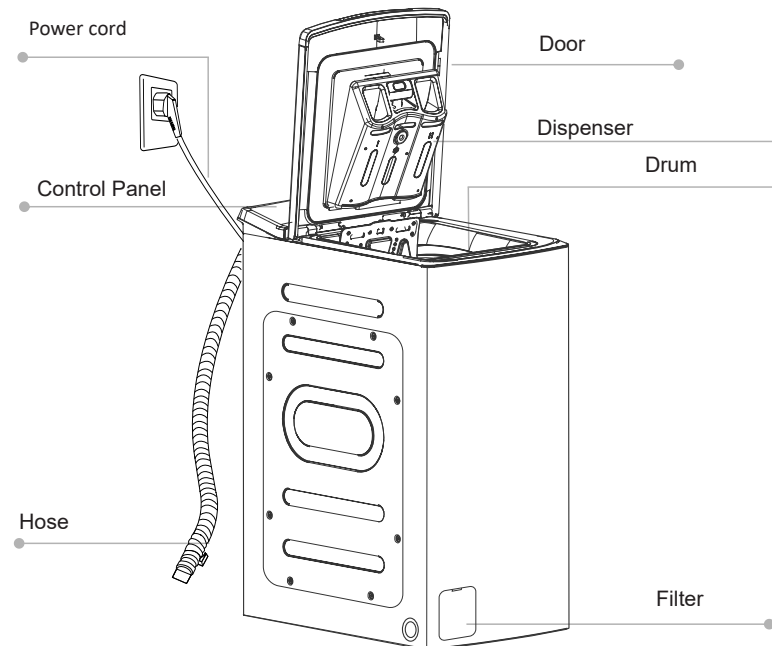
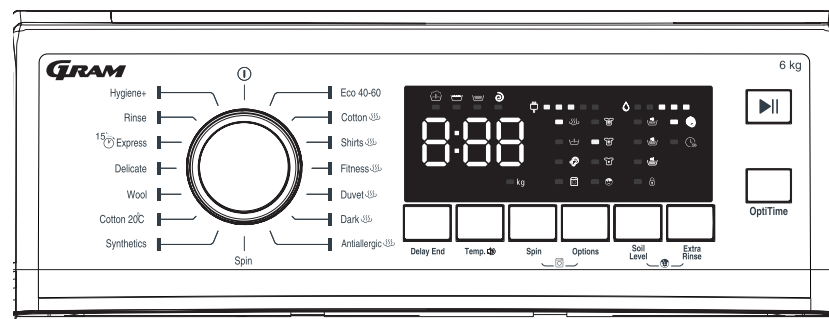

5 End of the wash

- End of the wash cycle is indicated by acoustic signal (if active). The display shows END and the door lock indicator light goes out.
- Close the water valve.
- Turn washing machine off.
- Unplug the appliance from the wall outlet.
- Open the door and remove laundry. Once clothes are removed, leave the door slightly ajar to allow the drum seal to dry before the door is closed properly. Leave the detergent drawer compartment slightly ajar to allow it to dry.

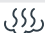

1. Delay End button
2. Temperature button
- Acoustic Signal On/Off
3. Spin button
4. Options button
5. Soil level button
6. Extra Rinse button
- 3+4 Drum self-cleaning
- 5+6. Child Lock

TABLE OF PROGRAMMES: WTL 20610-90

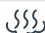
ITEM	Programme name	The default temperature	Default spin speed	Max. load [kg]	Additional functions available					Detergent drawer			Time [h:min]	Power consumption [wh]	Water consumption [l]	Number of rinses	Type of laundry
		[°C]	[RPM]		Delay End	Extra Rinse	Prewash	Steam	Silent Wash	Prewash ^I	Main wash ^{II}	Fabric softener ^{III}					
1	Eco 40-60	--	--	6	✓					✗	●	○	03:18	558	43	2	Use this programme to preserve colours of coloured clothes Default 40°C, cannot be selected, can be washed at around 40°C -60°C.
2	Cotton 	40°	800	6	✓	✓	✓		✓	○	●	○	02:40	871	58	2	Lightly soiled cotton or linen clothes.
3	Shirts 	30°	800	3	✓	✓	✓	✓	✓	○	●	○	01:00	333	37	2	Use this programme to wash clothes such as shirts.
4	Fitness 	20°	800	3	✓	✓	✓	✓	✓	○	●	○	00:45	169	37	2	Sports wear and leisure wear with Microfibre.
5	Duvet 	40°	800	2,5	✓	✓		✓	✓	✗	●	○	01:27	496	35	3	Moderately or heavily soiled cotton clothes, bed linen, table linen, undergarments, towels, linen fabrics.
6	Dark 	Cold water	800	3	✓	✓		✓	✓	✗	●	○	01:18	182	37	2	Dirty cotton, synthetics, coloured laundry, linen fabrics.
7	Antiallergic 	60°	800	3	✓	✓		✓	✓	✗	●	○	04:31	1211	37	4	The programme is designed for washing clothes of people with sensitive skin, e.g. children.
8	Spin	--	800	6	✓				✓	✗	✗	✗	00:12	45	--	0	Spin-drying after hand washing.
9	Synthetics	40°	800	3	✓	✓	✓		✓	○	●	○	02:20	648	37	2	Very dirty clothes, clothing made from synthetic fabrics or natural-synthetic fabric blends (nylon, shirts, blouses).
10	Cotton 20°C	20°	800	3	✓	✓			✓	✗	●	○	01:01	207	38	2	Use this programme to preserve colours of coloured clothes
11	Wool	40°	600	2	✓	✓			✓	✗	●	○	01:07	449	60	2	Note! Do not machine wash woollen fabrics if the cloth tag prohibits.
12	Delicate	30°	600	2,5	✓	✓			✓	✗	●	○	00:50	292	34	2	Very delicate fabrics.
13	Express 15'	Cold water	800	2	✓	✓			✓	✗	●	○	00:15	35	32	2	Very short programme, suitable for lightly soiled laundry, for example a small amount of laundry.
14	Rinse	--	800	6	✓	✓			✓	✗	✗	○	00:20	55	20	1	This programme is for rinsing with additives (such as anti-static or softening additives). Reduce the spin speed when washing very delicate fabrics.
15	Hygiene+	70°	800	3	✓	✓			✓	✗	●	○	02:27	1051	37	2	A washing machine can kill some bacteria and provide a hygienic effect.

* Use this programme to preserve colours of coloured clothes Default 40°C, cannot be selected, can be washed at around 40°C -60°C.

** The most efficient programmes in terms of energy and water consumption are generally those that are run at lower temperatures and for longer time.

*** You will save energy and water by loading your household appliance to the full capacity indicated by the manufacturer for the appropriate programmes.

NOTE:

NOTE:

Real water temperature may differ from the declared wash cycle temperature.

Time given is an estimate only. It can differ from the actual washing time depending on temperature, water pressure, and laundry load.

The time is automatically updated during the wash cycle, temporary time stops and lapses are normal.