

! Attention: Please read the operating manual prior to operating the machine for the first time.



- 1 Programme indicator lights
- 2 Rinse aid level indicator light
- 3 Salt level indicator light
- 4 LED progress indicator lights
- 5 Programme selection button
- 6 Start/Cancel button
- 7 Combi Tablet button
- 8 On/Off button

How to use your dishwasher:



- Open the water tap.
- Plug to the mains.
- Open the door and load the dishwasher. Check if both upper and lower spray arms move freely.
- Fill enough detergent into the detergent dispenser and close the door.
- Use the on / off button to turn the machine on.
- Check the salt and rinse aid level indicator lights. If necessary, refill salt and/or rinse aid.
- Use the programme selection button to choose your washing programme.
- When there are few dishes, additionally use the Half Load button.
- Start the programme with the Start/Pause button:

Attention

Avoid opening the door during the washing process. This interrupts the washing process, and hot steam will escape. When the door is closed, the programme will continue.

- Use the on / off button to turn the machine off again. When the progress indicator light "programme end" lights up, the programme is complete.
- Close the water tap. Pull out the plug.
- Allow your dishes to cool for 15 minutes, with the door open. Unload the dishes. Begin with the lower basket.

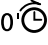
Programme Table

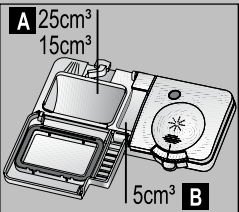
Programme number	1	2 Reference*	3	4
Programme name	 Pre-wash	eco	 60minA	 Intensive
Cleaning temperature	-	50°C	60°C	70°C
Degree of Soiling	Suitable for removing the remnants on the soiled dishes that will be kept waiting in the machine for a few days, and thus, for preventing the bad odor buildup.	Most economical washing program for the medium soiled daily dishes that are kept waiting.	Daily washing program at which the medium soiled dishes that are kept waiting are cleaned in the fastest way.	Suitable for heavily soiled dishes, pots and pans.
				
Detergents A=25 cm³/15 cm³ B=5 cm³	-	A+B	A+B	A+B
Programme sequence (without options)	Pre-wash ▼ End	Pre-wash ▼ Wash ▼ Cold rinse ▼ Hot Rinse ▼ Dry ▼ End	Wash ▼ Cold rinse ▼ Hot Rinse ▼ Dry ▼ End	Pre-wash ▼ Wash ▼ Cold rinse ▼ Hot Rinse ▼ Dry ▼ End
Duration (min)	14	185	60	115
Water (l)	4,2	15	11,8	17,5
Energy (kWh)	-	1,02	1,32	1,67

The consumption values shown in the table were determined under standard conditions. Differences may therefore occur under practical conditions.

* Reference programme for testing institutes The tests in accordance with EN 50242 must be carried out with a full water softener salt dispenser and a full rinse aid reservoir, and using the test programme.



- 1 Programme indicator lights
- 2 Rinse aid level indicator light
- 3 Salt level indicator light
- 4 LED progress indicator lights
- 5 Programme selection button
- 6 Start/Cancel button
- 7 Combi Tablet button
- 8 On/Off button

On/off button

You turn your dishwasher on / off with this button. When turning on, the indicator light for the last used programme will light up.

Visual Indicator

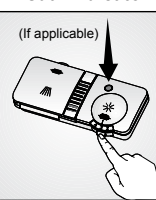

Rinse aid level indicator light

If this indicator light comes on, you have to refill rinse aid (If applicable).

You can also tell whether rinse aid must be refilled by looking at the rinse aid dispenser. When the visual fill indicator is dark, there is enough rinse aid in the dispenser.

When the colour is light, open the dispenser and refill rinse aid.

Program selection button

Use the programme selection button to select the desired programme. The corresponding programme light lights up.

Combi Tablet Button

Allows to obtain a better drying performance from the multi-purpose detergents called as all in one detergents such as 2in1, 3in1, 4in1, 5in1 and etc., depending on the hardness level of the tap water. The programs in which the Combi Tablet function can be enabled are indicated in the Program Data and Table of Average Consumption Values. Combi Tablet symbol lights up when you select the Combi Tablet function.

Start/cancel button

You use this button to start the selected program; the light on the button lights up.

Stop the program with the start/cancel button if you would like to open the door once the dishwasher's washing program is running.

- Wash ●
- Rinse ●
- Dry ●
- End ●

LED progress indicator lights

The program sequence throughout the washing process can be monitored from the progress indicator lights on the control panel.

! Warning

Following the washing stage, in order to drain and remove water from inside the machine completely, the machine will pause for approximately 35 minutes. Do not worry this is not a fault. Then End progress indicator light will come on.

! Warning

Do not switch the machine off before End light comes on.

How to cancel the washing program

Press start/cancel button for 3 seconds. The indicator light will start flashing. The machine will drain the water inside the machine for 45 seconds. The programme is cancelled when start/stop indicator light goes off. Then, you can choose and start a new programme.

! Important:

Depending on the stage of the program you have cancelled, there may be detergent residue or rinse aid inside the machine and on the load. Make sure the items in the dishwasher are not used before washing properly.

Improper Loading Of Dishware

