

## Dear Customer,

This Quick Start Guide is enclosed with detailed washing machine operating instructions. Before using the appliance carefully read the Operating Instructions, especially guidelines for safe use.

Before plugging the washing machine into the mains, remove the safety packaging and ensure the machine is level. Do not start the washing machine before it is properly set up.

Only wash delicate fabrics, synthetics, wool using designated programs. Such fabrics should only be washed in the maximum load sizes recommended (see page 2).

The correct washing machine operation extends its lifetime so make sure the drum seal is dry (leave the door ajar after washing). Do not clean the washing machine with harsh or abrasive detergents.

## 1 Preparing to wash

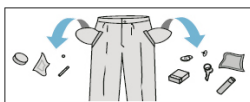

- Empty pockets
- Close all zips and button up duvet covers.
- Wash delicate and small items in a protective mesh laundry bag.
- Open the door of the washing machine by gripping the door and the door handle on the inside of the door.
- Insert the sorted clothes into the washing machine:
  - Cotton — max full drum.
  - Synthetics — max ½ of the drum.
  - Silk, wool — max 1/3 of the drum.
- Close the door, press firmly against the seal.

## 2 Add detergent

- Open the detergent drawer. Pull the handle.
- Pour the recommended dose of washing detergent into the appropriate compartment of the detergent drawer.
- Add fabric conditioner to the appropriate compartment if required.
  - II MAIN WASH detergent.
  - III Fabric softener or other special care liquids.
  - I PREWASH detergent.

## 3 Program selections

- Set the programme selector knob to the desired programme.
- Customize the programme to your needs — you can change the temperature, spin speed, or enable additional features.
- Select additional functions. The additional functions are described on the control panel and in the "Table of Wash Programmes" (see page 2).

## 4 Select START

- Close the appliance door.
- Set the programme selector dial to the desired programme (see page 2).
- Select additional functions or wash cycle parameters as required – according to your needs.
- Select Delay ranging from 0 to 24 hours.
- Then press the START/ PAUSE button

## 5 End of the wash

- End of the wash cycle is indicated by acoustic signal (if active). The display shows END and the door lock indicator light goes out.
- Close the water valve.
- Turn washing machine off.
- Unplug the appliance from the mains.
- Open the door and remove laundry. Once clothes are removed, leave the door slightly ajar to allow the drum seal to dry before the door is closed properly. Leave the detergent drawer compartment slightly ajar to allow it to dry.



1. Detergent drawer
2. Drum
3. Programme selector dial
4. Control Panel / Display
5. Door handle
6. Pump filter cover

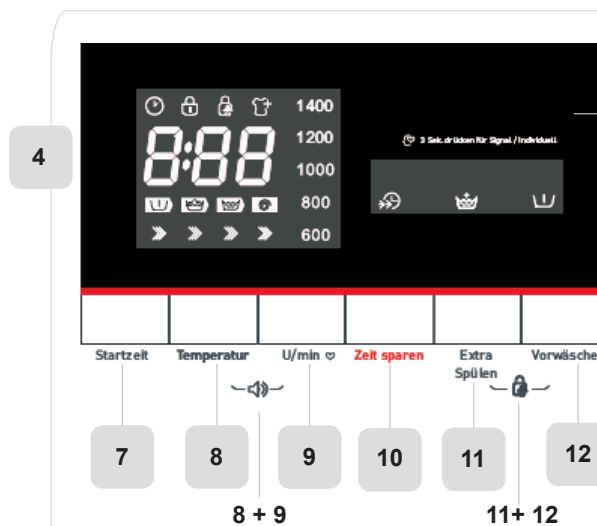
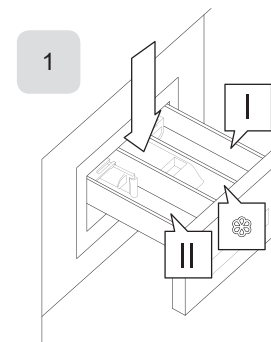

7. Delay button
8. Temperature button
9. Spin Button
10. Rapid Wash button
11. Extra Rinse button
12. Prewash button

8+9 Acoustic Signal On/Off  
11+12. Child Lock

TABLE OF WASH PROGRAMMES: **WA 14690-1 W**

ITEM	Programme name	The default temperature [°C]	Max. spin speed [RPM]	Max. load [kg]	Additional functions available				Detergent drawer			Time [h:min]	Energy consumption [kWh]	Water consumption [l]	Number of rinses	Type of laundry
					Extra Rinse		Delay		Prewash <sup>I</sup>	Main wash <sup>II</sup>	Fabric softener <sup>III</sup>					
1	Quick 15'	Cold water	800	2.0			✓		✗	●	○	0:15	14	41	2	Extra short programme approx. suitable for lightly soiled washing as a small amounts of laundry.
2	Rapid 45'	40°	800	2.0			✓		✗	●	○	0:45	700	40	2	Washing few and not very dirty clothes quickly.
3	Sport Wear	20°	800	7.0	✓		✓		○	●	○	0:45	100	44	2	Washing the activewear.
4	Wool	40°	600	2.0	✓		✓		✗	●	○	1:07	633	57	2	Hand or machine-washable wool or richwool textiles.Especially gentle wash programme to prevent shrinkage, longer programme pauses (textiles rest in wash liquor).
5	Delicate	30°	600	7.0	✓		✓		✗	●	○	0:50	400	50	2	Very delicate fabrics, e.g. silk.
6	ECO 40-60	--	1400	7.0			✓		✗	●	○	3:13	775	55	2	The "eco 40-60" program is designed for washing normally soiled cotton fabrics considered suitable for washing at 40 ° C or 60 ° C, together in the same cycle.
7	Intensive	40°	800	7.0			✓		✗	●	○	3:48	1050	68	2	To increase the washing effects, washing time is increased.
8	Spin Only	--	1000	7.0			✓		✗	✗	✗	0:12	22	--	-	Extra spin with selectable spin speed.
9	Rinse&Spin	--	1000	7.0	✓		✓		✗	✗	○	0:20	24	26	1	Extra rinse with spin.
10	20°	20°	1000	7.0	✓		✓		✗	●	○	1:01	90	50	2	Washing brightly colored clothes, it can protect the colors better.
11	Mix	40°	800	7.0	✓		✓		○	●	○	1:20	790	59	2	Mixed load consisting of textiles made of cotton and synthetics.
12	Jeans	30°	1000	7.0	✓		✓		○	●	○	1:35	1155	68	2	Specially for jeans.
13	Baby Care	60°	800	7.0	✓		✓		○	●	○	1:42	95	74	2	Washing the baby's clothes, it can make the baby's wear cleaner and make the rinse performance better to protect the baby skin.
14	Synthetics	40°	1200	3.5	✓		✓		○	●	○	3:17	680	55	2	Wash synthetic articles, for example: shirts, coats, blending. While washing the knitting textiles, detergent quantity shall be reduced due to its loose string construction and easily forming bubbles.
15	Cotton	40°	1400	7.0	✓		✓		○	●	○	3:39	950	71	2	Hard-wearing textiles, heat-resistant textiles made of cotton or linen.
16	My Cycle															To save frequently used programme settings.

\* The "eco 40-60" program is designed for washing normally soiled cotton fabrics considered suitable for washing at 40 ° C or 60 ° C, together in the same cycle.

\*\* The most energy and water efficient wash programmes are generally those that run at lower temperature and for a long time.

\*\*\* Loading the washing machine to the full capacity indicated by the manufacturer for the respective wash programmes will save energy and water.

**NOTE:**  
**NOTE:**

Real water temperature may differ from the declared wash cycle temperature.

Above mentioned time is an estimate and may differ from actual wash cycle time, depending on temperature, water pressure, load size, etc. The time is automatically updated during wash cycle. Displaying the same time for an extended period or abrupt changes are normal.